

- NOTES**
1. ALL DIMENSIONS ARE IN METRES UNLESS STATED OTHERWISE.
 2. THESE LAND PLANS SHOULD BE READ IN CONJUNCTION WITH OTHER PLANS AND DOCUMENTS IN THE DEVELOPMENT CONSENT ORDER, IN PARTICULAR THE BOOK OF REFERENCE.
 3. ALL EASEMENTS, SERVITUDES AND PRIVATE RIGHTS ARE PROPOSED TO BE EXTINGUISHED ON LAND THAT IS TO BE ACQUIRED, UNLESS STATED OTHERWISE IN THE BOOK OF REFERENCE.

KEY
 DEVELOPMENT CONSENT ORDER (DCO) BOUNDARY

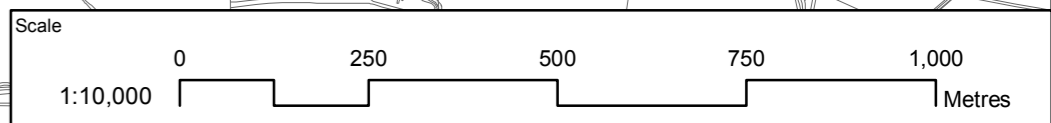

Project Title A303 SPARKFORD TO ILCHESTER DUALLING					
Drawing Title LAND PLANS REGULATION 5(2)(i) KEY PLAN					
Drawing Status PUBLISHED - DEFINITION					Suitability A3
Scale 1:10,000	Designed GP	Drawn GP	Checked AL	Approved ER	
Original Size A1	Date 06/06/18	Date 11/07/18	Date 16/07/18	Date 16/07/18	
Drawing Number C04	HE PIN 26/03/2019	Originator SUBMISSION FOR DEADLINE 5	Volume - MMSJV - LSI -	Project Ref. No. 389107	
000	- DR - UU - 2016	000		Revision C04	
REV.	DATE	AMENDMENT DETAILS	ORIG	CHD	APPD

PLEASE NOTE, THE OS DATA DISPLAYED IS IN ADHERENCE TO © CROWN COPYRIGHT AND DATABASE RIGHTS 2018 OS 100030649. THIS DOCUMENT IS ISSUED FOR THE PARTY WHICH COMMISSIONED IT AND FOR SPECIFIC PURPOSES CONNECTED WITH THE CAPTIONED PROJECT ONLY. IT SHOULD NOT BE RELIED UPON BY ANY OTHER PARTY OR USED FOR ANY OTHER PURPOSE. WE ACCEPT NO RESPONSIBILITY FOR THE CONSEQUENCES OF THIS DOCUMENT BEING RELIED UPON BY ANY OTHER PARTY, OR BEING USED FOR ANY OTHER PURPOSE, OR CONTAINING ANY ERROR OR OMISSION WHICH IS DUE TO AN ERROR OR OMISSION IN DATA SUPPLIED TO US BY OTHER PARTIES.

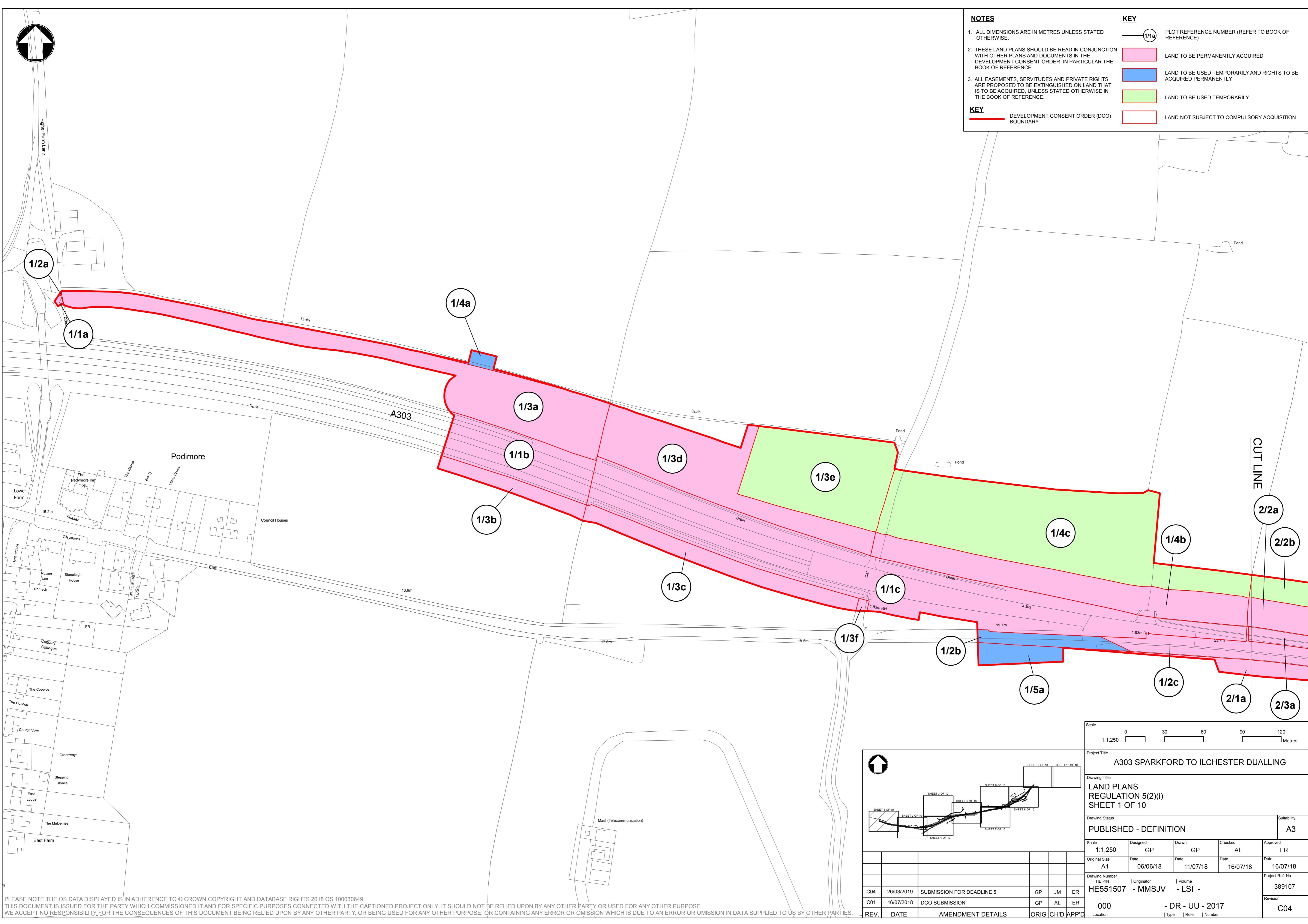

NOTES

1. ALL DIMENSIONS ARE IN METRES UNLESS STATED OTHERWISE.
2. THESE LAND PLANS SHOULD BE READ IN CONJUNCTION WITH OTHER PLANS AND DOCUMENTS IN THE DEVELOPMENT CONSENT ORDER, IN PARTICULAR THE BOOK OF REFERENCE.
3. ALL EASEMENTS, SERVITUDES AND PRIVATE RIGHTS ARE PROPOSED TO BE EXTINGUISHED ON LAND THAT IS TO BE ACQUIRED, UNLESS STATED OTHERWISE IN THE BOOK OF REFERENCE.

KEY

- DEVELOPMENT CONSENT ORDER (DCO) BOUNDARY
- (1/1a) PLOT REFERENCE NUMBER (REFER TO BOOK OF REFERENCE)
- LAND TO BE PERMANENTLY ACQUIRED
- LAND TO BE USED TEMPORARILY AND RIGHTS TO BE ACQUIRED PERMANENTLY
- LAND TO BE USED TEMPORARILY
- LAND NOT SUBJECT TO COMPULSORY ACQUISITION

PLEASE NOTE THE OS DATA DISPLAYED IS IN ADHERENCE TO © CROWN COPYRIGHT AND DATABASE RIGHTS 2018 OS 100030649. THIS DOCUMENT IS ISSUED FOR THE PARTY WHICH COMMISSIONED IT AND FOR SPECIFIC PURPOSES CONNECTED WITH THE CAPTIONED PROJECT ONLY. IT SHOULD NOT BE RELIED UPON BY ANY OTHER PARTY OR USED FOR ANY OTHER PURPOSE. WE ACCEPT NO RESPONSIBILITY FOR THE CONSEQUENCES OF THIS DOCUMENT BEING RELIED UPON BY ANY OTHER PARTY, OR BEING USED FOR ANY OTHER PURPOSE, OR CONTAINING ANY ERROR OR OMISSION WHICH IS DUE TO AN ERROR OR OMISSION IN DATA SUPPLIED TO US BY OTHER PARTIES.

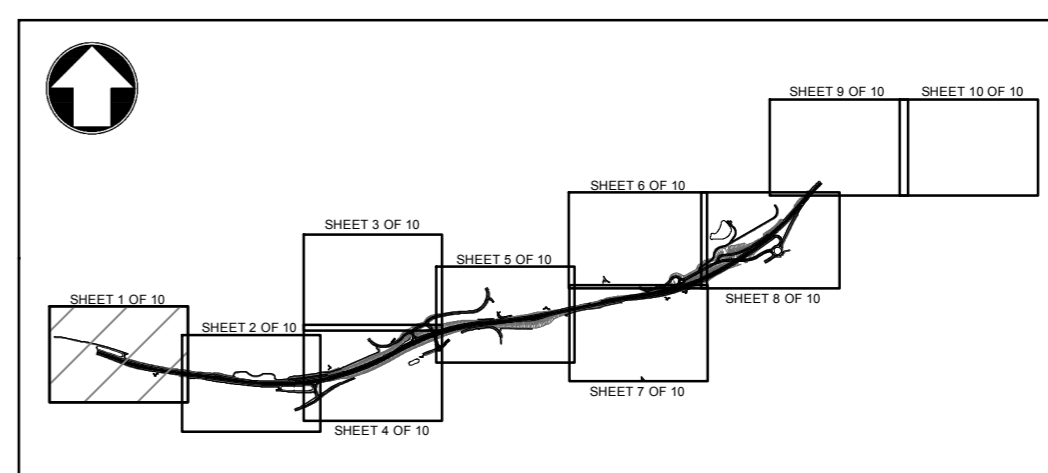

Scale 1:1,250 0 30 60 90 120 Metres					
Project Title A303 SPARKFORD TO ILCHESTER DUALLING					
Drawing Title LAND PLANS REGULATION 5(2)(i) SHEET 1 OF 10					
Drawing Status PUBLISHED - DEFINITION					Subsidiarity A3
Scale 1:1,250	Designed GP	Drawn GP	Checked AL	Approved ER	
Original Size A1	Date 06/06/18	Date 11/07/18	Date 16/07/18	Date 16/07/18	
Drawing Number HE PIN HE551507 - MMSJV			Volume - LSI -		Project Ref. No. 389107
REV. DATE AMENDMENT DETAILS			ORIG CHD APPD		Revision C04
Location 000			Type Role Number - DR - UU - 2017		

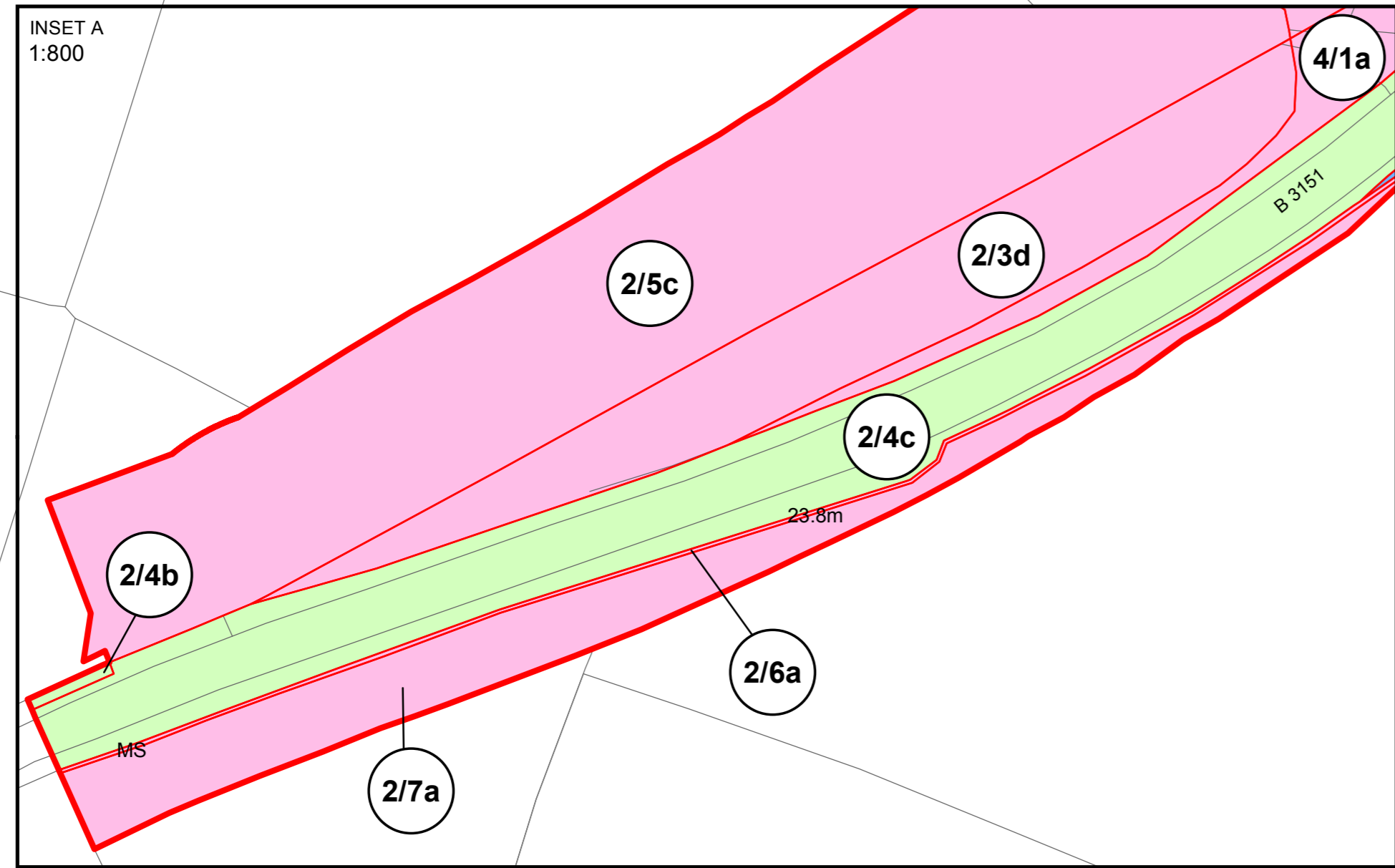

NOTES

1. ALL DIMENSIONS ARE IN METRES UNLESS STATED OTHERWISE.
2. THESE LAND PLANS SHOULD BE READ IN CONJUNCTION WITH OTHER PLANS AND DOCUMENTS IN THE DEVELOPMENT CONSENT ORDER, IN PARTICULAR THE BOOK OF REFERENCE.
3. ALL EASEMENTS, SERVITUDES AND PRIVATE RIGHTS ARE PROPOSED TO BE EXTINGUISHED ON LAND THAT IS TO BE ACQUIRED, UNLESS STATED OTHERWISE IN THE BOOK OF REFERENCE.

KEY

- 1/1a PLOT REFERENCE NUMBER (REFER TO BOOK OF REFERENCE)
- LAND TO BE PERMANENTLY ACQUIRED
- LAND TO BE USED TEMPORARILY AND RIGHTS TO BE ACQUIRED PERMANENTLY
- LAND TO BE USED TEMPORARILY
- LAND NOT SUBJECT TO COMPULSORY ACQUISITION
- DEVELOPMENT CONSENT ORDER (DCO) BOUNDARY

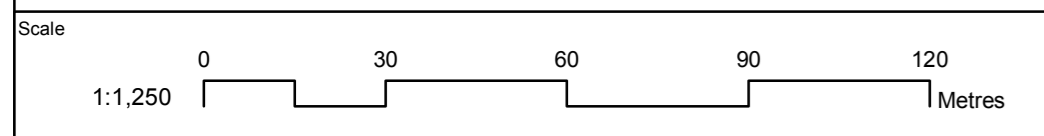
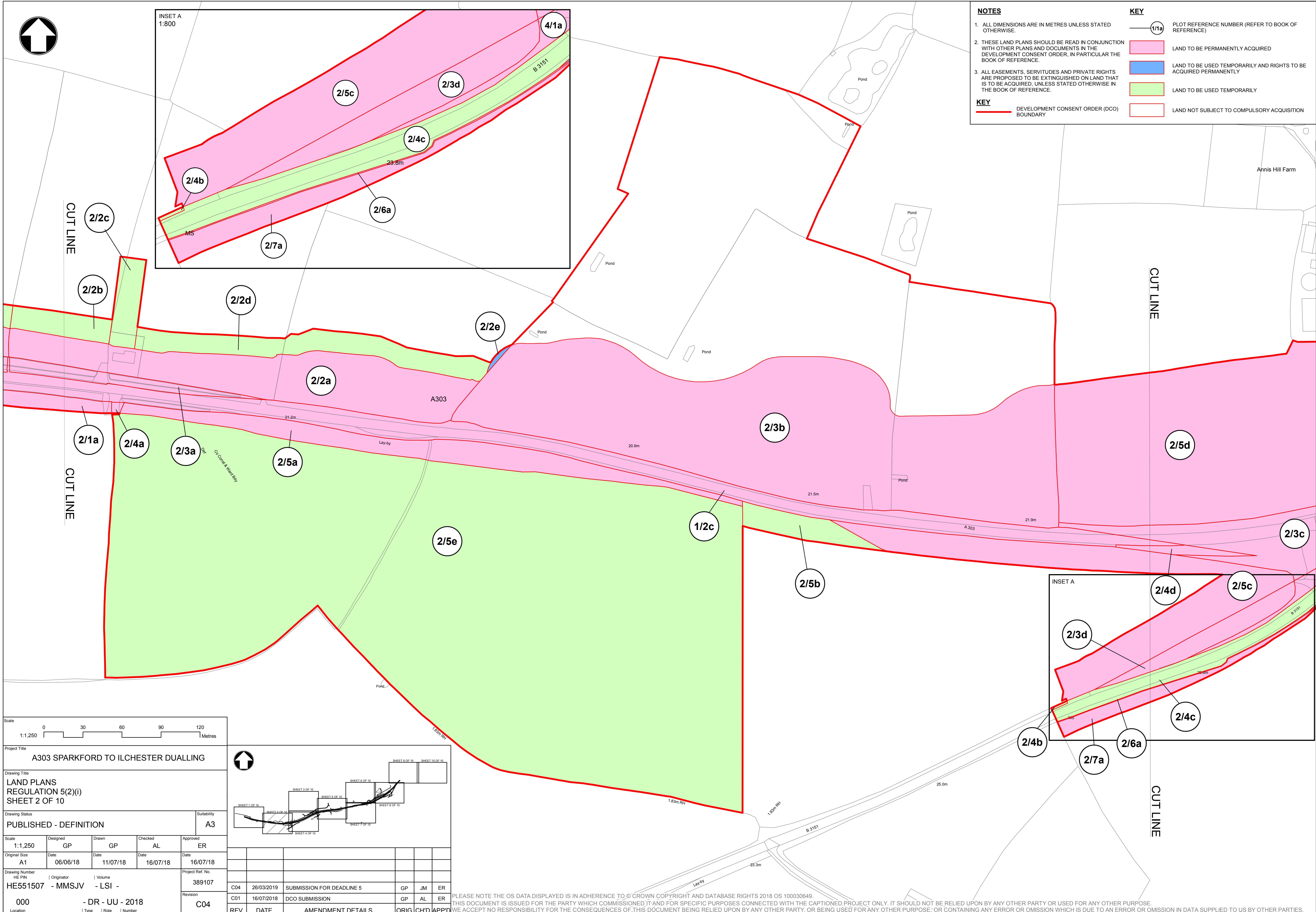

Project Title A303 SPARKFORD TO ILCHESTER DUALLING					
Drawing Title LAND PLANS REGULATION 5(2)(i) SHEET 2 OF 10					
Drawing Status PUBLISHED - DEFINITION					Subsidiary A3
Scale 1:1,250	Designed GP	Drawn GP	Checked AL	Approved ER	
Original Size A1	Date 06/06/18	Date 11/07/18	Date 16/07/18	Date 16/07/18	
Drawing Number HE551507	Originator - MMSJV	Volume - LSI -	Project Ref. No. 389107		
000	- DR - UU - 2018		Revision C04		
Location	Type	Role	Number	REV. DATE AMENDMENT DETAILS ORIG CHD APPD	

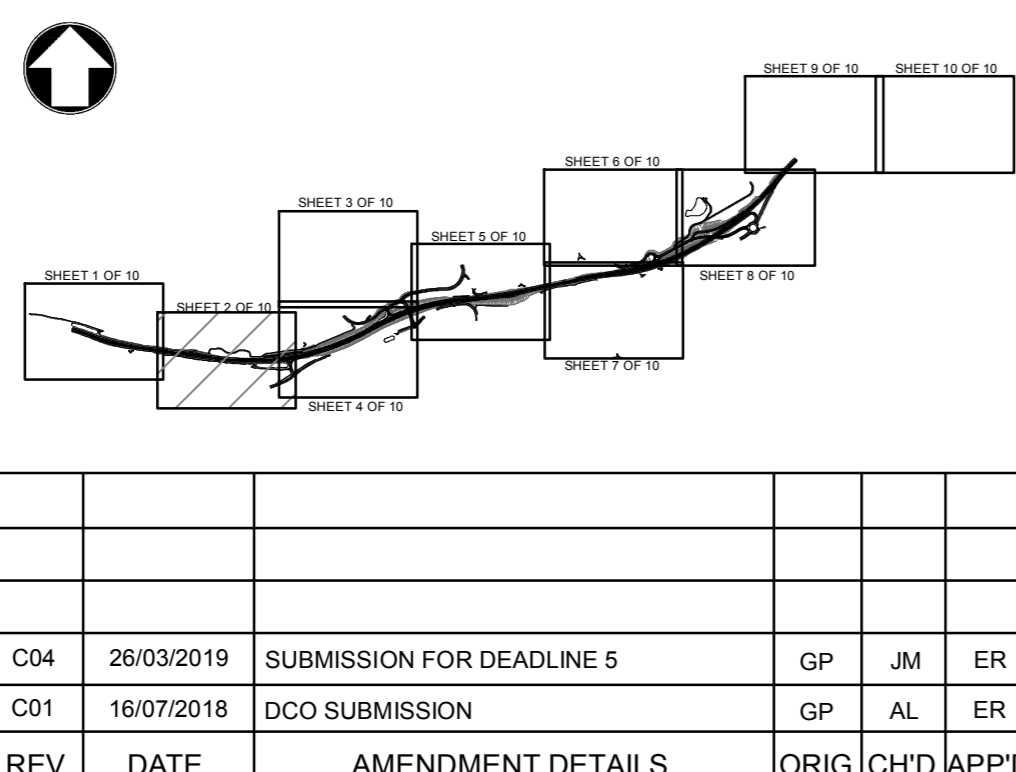

PLEASE NOTE THE OS DATA DISPLAYED IS IN ADHERENCE TO © CROWN COPYRIGHT AND DATABASE RIGHTS 2018 OS 100030649. THIS DOCUMENT IS ISSUED FOR THE PARTY WHICH COMMISSIONED IT AND FOR SPECIFIC PURPOSES CONNECTED WITH THE CAPTIONED PROJECT ONLY. IT SHOULD NOT BE RELIED UPON BY ANY OTHER PARTY OR USED FOR ANY OTHER PURPOSE. WE ACCEPT NO RESPONSIBILITY FOR THE CONSEQUENCES OF THIS DOCUMENT BEING RELIED UPON BY ANY OTHER PARTY, OR BEING USED FOR ANY OTHER PURPOSE, OR CONTAINING ANY ERROR OR OMISSION WHICH IS DUE TO AN ERROR OR OMISSION IN DATA SUPPLIED TO US BY OTHER PARTIES.

THIS DOCUMENT IS ISSUED FOR THE PARTY WHICH COMMISSIONED IT AND FOR SPECIFIC PURPOSES CONNECTED WITH THE CAPTIONED PROJECT ONLY. IT SHOULD NOT BE RELIED UPON BY ANY OTHER PARTY OR USED FOR ANY OTHER PURPOSE. WE ACCEPT NO RESPONSIBILITY FOR THE CONSEQUENCES OF THIS DOCUMENT BEING RELIED UPON BY ANY OTHER PARTY, OR BEING USED FOR ANY OTHER PURPOSE, OR CONTAINING ANY ERROR OR OMISSION WHICH IS DUE TO AN ERROR OR OMISSION IN DATA SUPPLIED TO US BY OTHER PARTIES. PLEASE NOTE THE OS DATA DISPLAYED IS IN ADHERENCE TO © CROWN COPYRIGHT AND DATABASE RIGHTS 2018 OS 100030649.

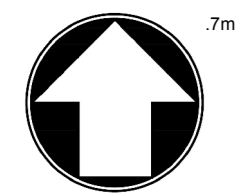

NOTES

1. ALL DIMENSIONS ARE IN METRES UNLESS STATED OTHERWISE.
2. THESE LAND PLANS SHOULD BE READ IN CONJUNCTION WITH OTHER PLANS AND DOCUMENTS IN THE DEVELOPMENT CONSENT ORDER, IN PARTICULAR THE BOOK OF REFERENCE.
3. ALL EASEMENTS, SERVITUDES AND PRIVATE RIGHTS ARE PROPOSED TO BE EXTINGUISHED ON LAND THAT IS TO BE ACQUIRED, UNLESS STATED OTHERWISE IN THE BOOK OF REFERENCE.

KEY

- (1/1a) PLOT REFERENCE NUMBER (REFER TO BOOK OF REFERENCE)
- LAND TO BE PERMANENTLY ACQUIRED
- LAND TO BE USED TEMPORARILY AND RIGHTS TO BE ACQUIRED PERMANENTLY
- LAND TO BE USED TEMPORARILY
- LAND NOT SUBJECT TO COMPULSORY ACQUISITION BOUNDARY

KEY

- DEVELOPMENT CONSENT ORDER (DCO) BOUNDARY

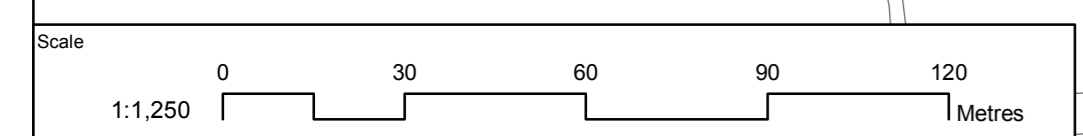
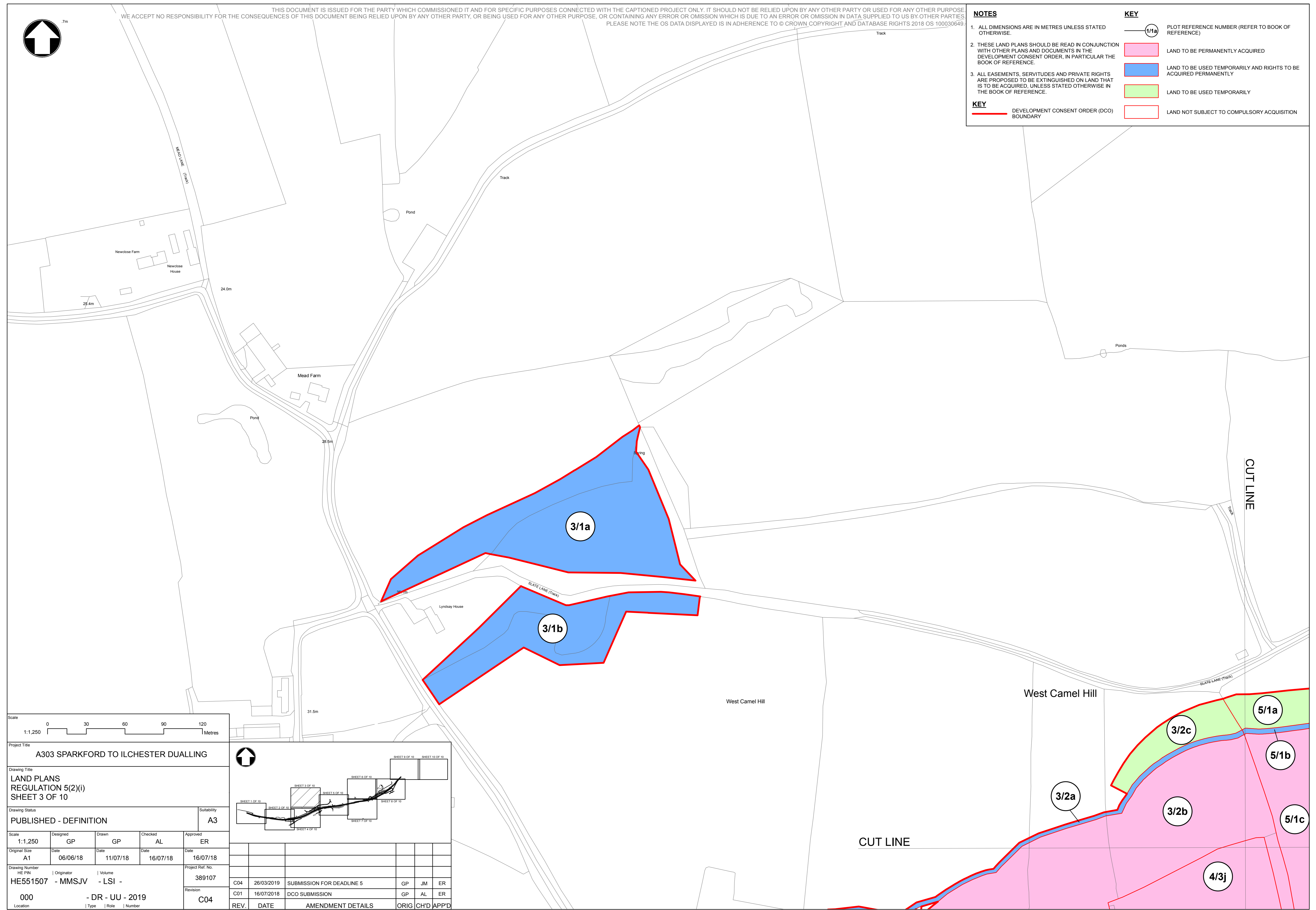

Project Title A303 SPARKFORD TO ILCHESTER DUALLING					
Drawing Title LAND PLANS REGULATION 5(2)(i) SHEET 3 OF 10					
Drawing Status PUBLISHED - DEFINITION					Suitability A3
Scale 1:1,250	Designed GP	Drawn GP	Checked AL	Approved ER	
Original Size A1	Date 06/06/18	Date 11/07/18	Date 16/07/18	Date 16/07/18	Date 16/07/18
Drawing Number HE551507	Originator - MMSJV	Volume - LSI -	Project Ref. No. 389107		
000	- DR - UU - 2019		Revision C04		
Location	Type	Role	Number	REV.	DATE

C04	26/03/2019	SUBMISSION FOR DEADLINE 5	GP	JM	ER
C01	16/07/2018	DCO SUBMISSION	GP	AL	ER
REV.	DATE	AMENDMENT DETAILS	ORIG	CHD	APP'D

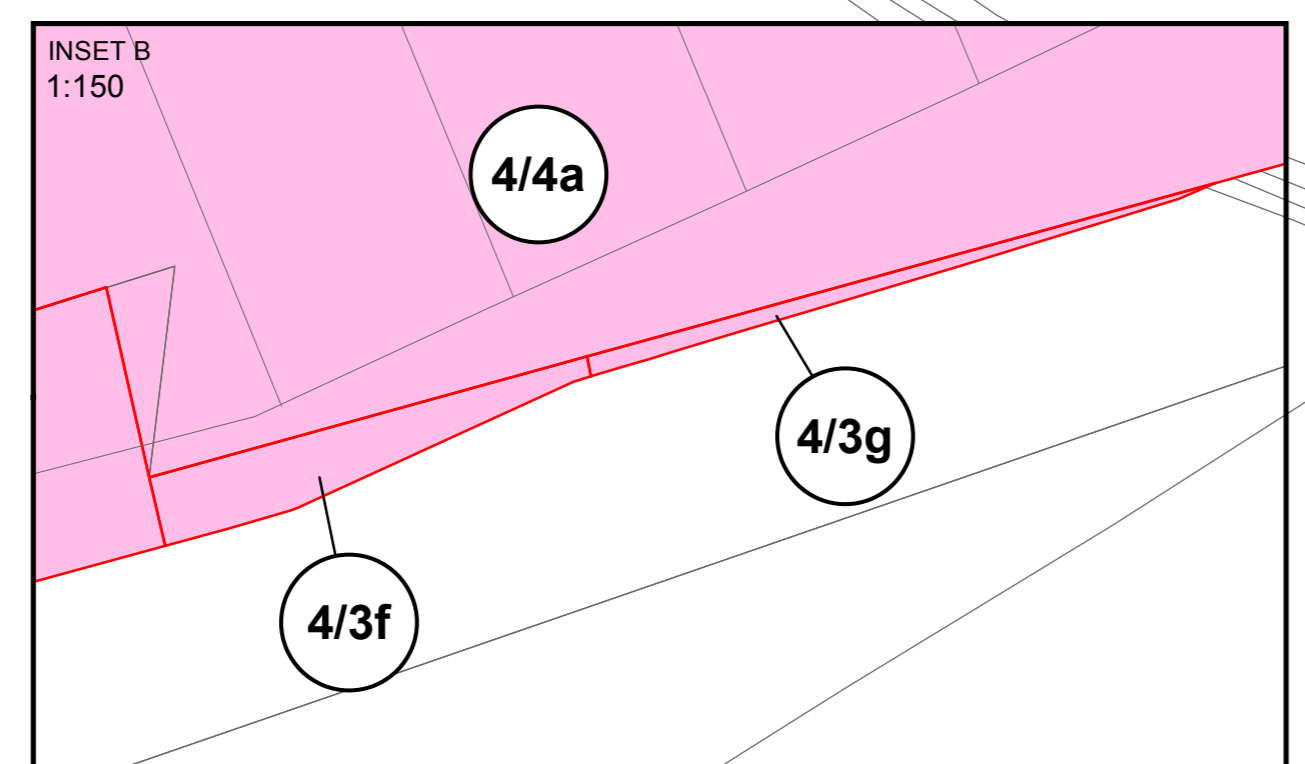
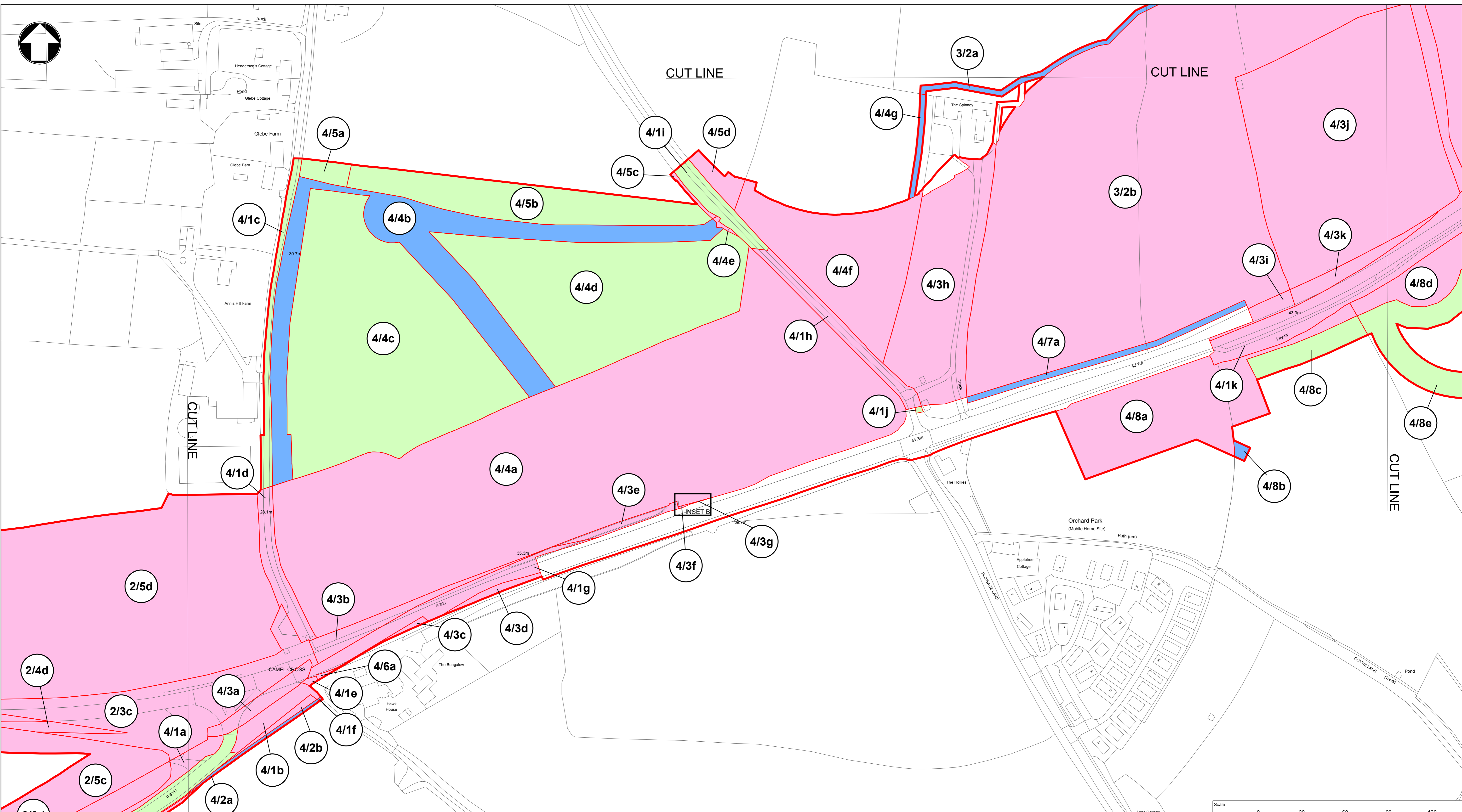

NOTES

- ALL DIMENSIONS ARE IN METRES UNLESS STATED OTHERWISE.
- THESE LAND PLANS SHOULD BE READ IN CONJUNCTION WITH OTHER PLANS AND DOCUMENTS IN THE DEVELOPMENT CONSENT ORDER, IN PARTICULAR THE BOOK OF REFERENCE.
- ALL EASEMENTS, SERVITUDES AND PRIVATE RIGHTS ARE PROPOSED TO BE EXTINGUISHED ON LAND THAT IS TO BE ACQUIRED, UNLESS STATED OTHERWISE IN THE BOOK OF REFERENCE.

KEY

	DEVELOPMENT CONSENT ORDER (DCO) BOUNDARY		LAND TO BE PERMANENTLY ACQUIRED
	LAND TO BE USED TEMPORARILY AND RIGHTS TO BE ACQUIRED PERMANENTLY		LAND TO BE USED TEMPORARILY
	LAND NOT SUBJECT TO COMPULSORY ACQUISITION		

KEY

	PLOT REFERENCE NUMBER (REFER TO BOOK OF REFERENCE)
--	--

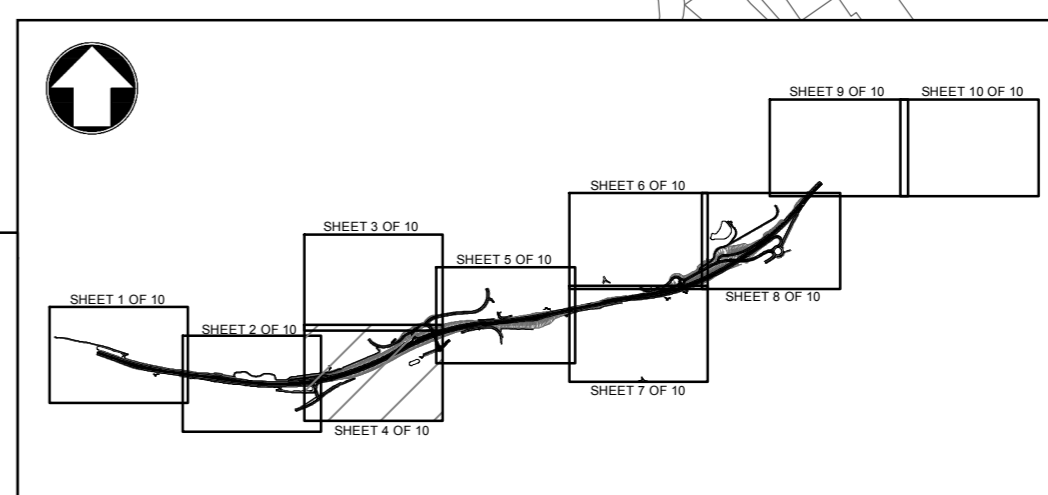

Scale 1:1,250 0 30 60 90 120 Metres					
Project Title A303 SPARKFORD TO ILCHESTER DUALLING					
Drawing Title LAND PLANS REGULATION 5(2)(i) SHEET 4 OF 10					
Drawing Status PUBLISHED - DEFINITION					Suitability A3
Scale 1:1,250	Designed GP	Drawn GP	Checked AL	Approved ER	
Original Size A1	Date 06/06/18	Date 11/07/18	Date 16/07/18	Date 16/07/18	
Drawing Number HE PIN 000	Originator - MMSJV	Volume - LSI -	Project Ref. No. 389107		
REV.	DATE	AMENDMENT DETAILS	ORIG	CH'D	APP'D
C04	26/03/2019	SUBMISSION FOR DEADLINE 5	GP	JM	ER
C01	16/07/2018	DCO SUBMISSION	GP	AL	ER
Location - DR - UU - 2020			Revision C04		

PLEASE NOTE THE OS DATA DISPLAYED IS IN ADHERENCE TO © CROWN COPYRIGHT AND DATABASE RIGHTS 2018 OS 100030649.

THIS DOCUMENT IS ISSUED FOR THE PARTY WHICH COMMISSIONED IT AND FOR SPECIFIC PURPOSES CONNECTED WITH THE CAPTIONED PROJECT ONLY. IT SHOULD NOT BE RELIED UPON BY ANY OTHER PARTY OR USED FOR ANY OTHER PURPOSE. WE ACCEPT NO RESPONSIBILITY FOR THE CONSEQUENCES OF THIS DOCUMENT BEING RELIED UPON BY ANY OTHER PARTY, OR BEING USED FOR ANY OTHER PURPOSE, OR CONTAINING ANY ERROR OR OMISSION WHICH IS DUE TO AN ERROR OR OMISSION IN DATA SUPPLIED TO US BY OTHER PARTIES.

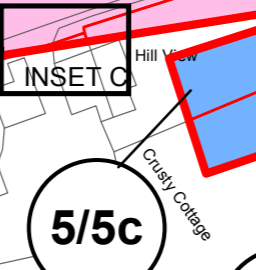
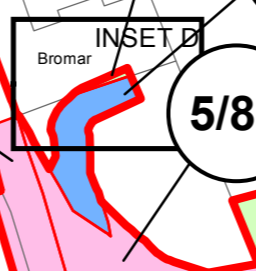
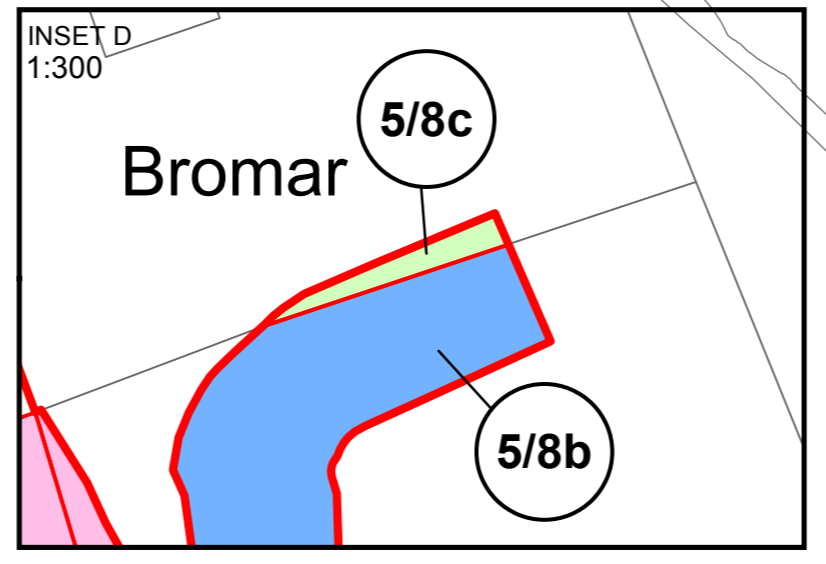
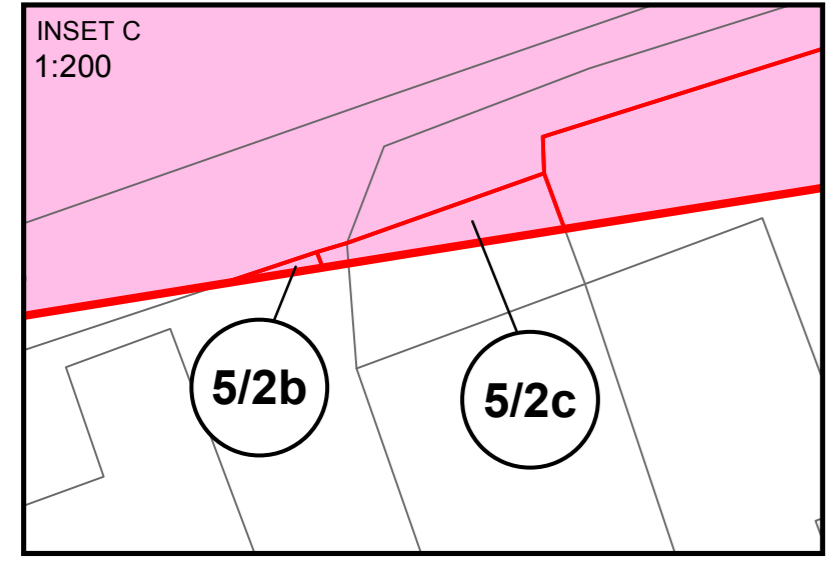
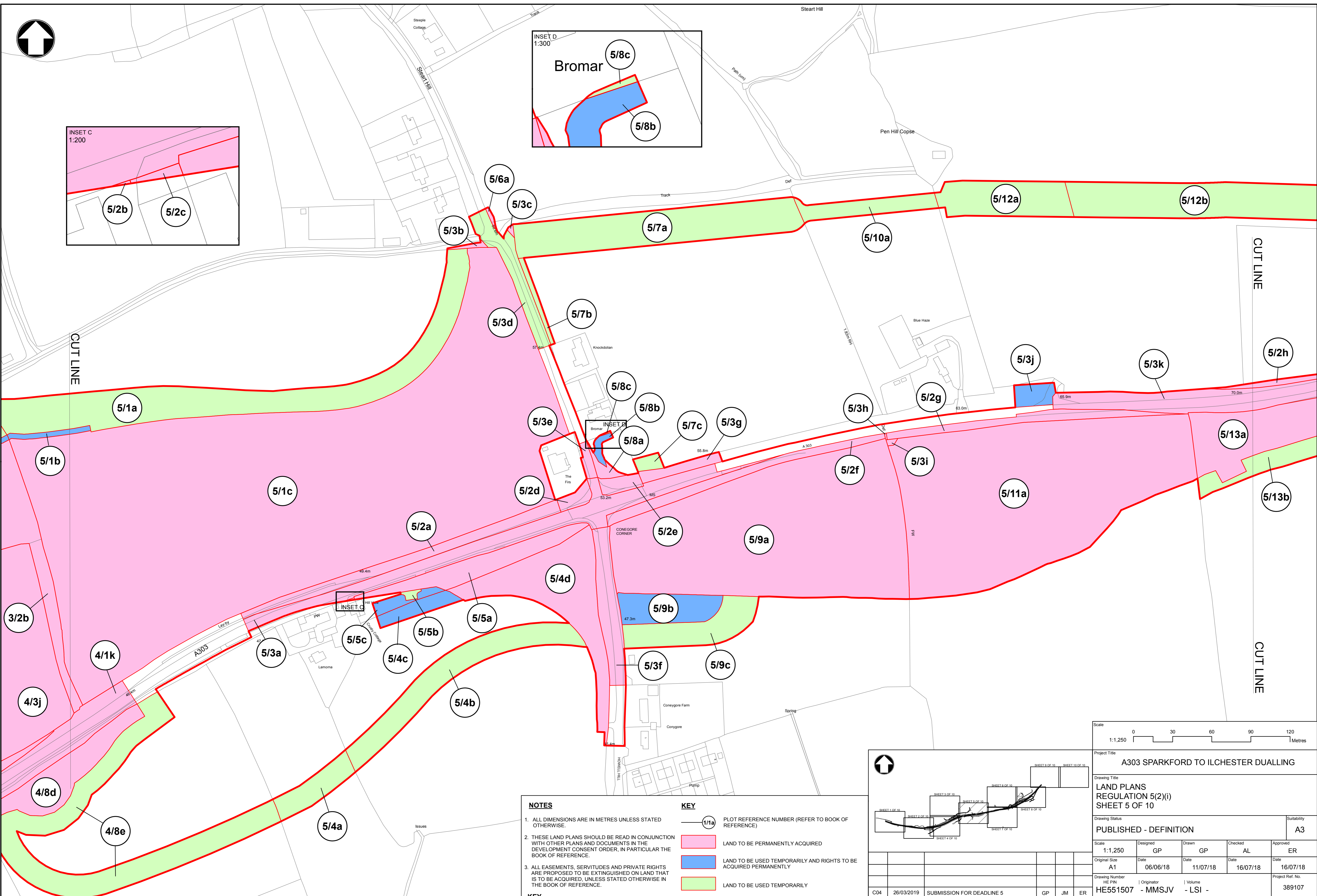

NOTES

- ALL DIMENSIONS ARE IN METRES UNLESS STATED OTHERWISE.
- THESE LAND PLANS SHOULD BE READ IN CONJUNCTION WITH OTHER PLANS AND DOCUMENTS IN THE DEVELOPMENT CONSENT ORDER, IN PARTICULAR THE BOOK OF REFERENCE.
- ALL EASEMENTS, SERVITUDES AND PRIVATE RIGHTS ARE PROPOSED TO BE EXTINGUISHED ON LAND THAT IS TO BE ACQUIRED, UNLESS STATED OTHERWISE IN THE BOOK OF REFERENCE.

KEY

- DEVELOPMENT CONSENT ORDER (DCO) BOUNDARY
- (1/1a) PLOT REFERENCE NUMBER (REFER TO BOOK OF REFERENCE)
- LAND TO BE PERMANENTLY ACQUIRED
- LAND TO BE USED TEMPORARILY AND RIGHTS TO BE ACQUIRED PERMANENTLY
- LAND TO BE USED TEMPORARILY
- LAND NOT SUBJECT TO COMPULSORY ACQUISITION

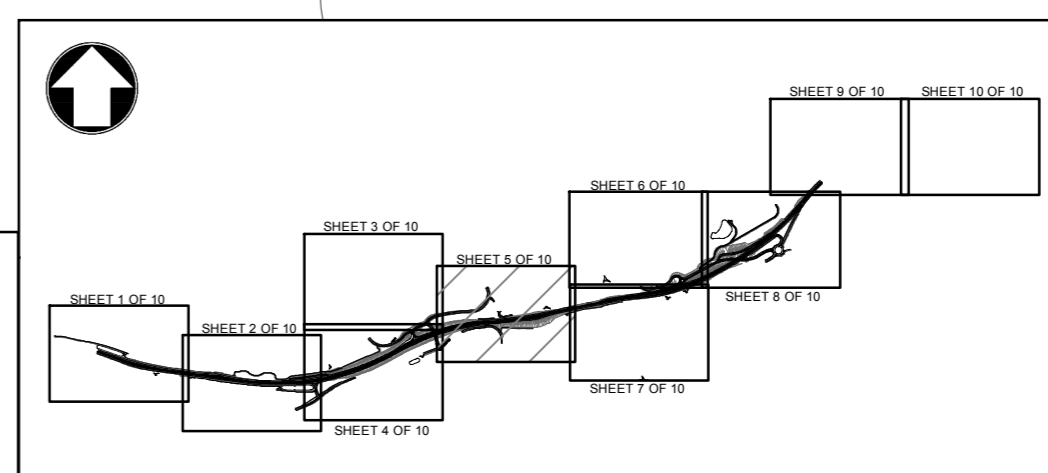

Scale 1:1,250 0 30 60 90 120 Metres					
Project Title A303 SPARKFORD TO ILCHESTER DUALLING					
Drawing Title LAND PLANS REGULATION 5(2)(i) SHEET 5 OF 10					
Drawing Status PUBLISHED - DEFINITION					Subsidiarity A3
Scale 1:1,250	Designed GP	Drawn GP	Checked AL	Approved ER	
Original Size A1	Date 06/06/18	Date 11/07/18	Date 16/07/18	Date 16/07/18	
Drawing Number HE PIN C04	Originator - MMSJV	Volume - LSI -	Project Ref. No. 389107		
000	- DR - UU - 2021		Revision C04		
Location	Type	Role	Number		
REV.	DATE	AMENDMENT DETAILS	ORIG	CH'D	APP'D

PLEASE NOTE THE OS DATA DISPLAYED IS IN ADHERENCE TO © CROWN COPYRIGHT AND DATABASE RIGHTS 2018 OS 100030649.
THIS DOCUMENT IS ISSUED FOR THE PARTY WHICH COMMISSIONED IT AND FOR SPECIFIC PURPOSES CONNECTED WITH THE CAPTIONED PROJECT ONLY. IT SHOULD NOT BE RELIED UPON BY ANY OTHER PARTY OR USED FOR ANY OTHER PURPOSE.
WE ACCEPT NO RESPONSIBILITY FOR THE CONSEQUENCES OF THIS DOCUMENT BEING RELIED UPON BY ANY OTHER PARTY, OR BEING USED FOR ANY OTHER PURPOSE, OR CONTAINING ANY ERROR OR OMISSION WHICH IS DUE TO AN ERROR OR OMISSION IN DATA SUPPLIED TO US BY OTHER PARTIES.



NOTES

1. ALL DIMENSIONS ARE IN METRES UNLESS STATED OTHERWISE.
2. THESE LAND PLANS SHOULD BE READ IN CONJUNCTION WITH OTHER PLANS AND DOCUMENTS IN THE DEVELOPMENT CONSENT ORDER, IN PARTICULAR THE BOOK OF REFERENCE.
3. ALL EASEMENTS, SERVITUDES AND PRIVATE RIGHTS ARE PROPOSED TO BE EXTINGUISHED ON LAND THAT IS TO BE ACQUIRED, UNLESS STATED OTHERWISE IN THE BOOK OF REFERENCE.

KEY

— DEVELOPMENT CONSENT ORDER (DCO) BOUNDARY

KEY

- (1/1a) PLOT REFERENCE NUMBER (REFER TO BOOK OF REFERENCE)
- LAND TO BE PERMANENTLY ACQUIRED
- LAND TO BE USED TEMPORARILY AND RIGHTS TO BE ACQUIRED PERMANENTLY
- LAND TO BE USED TEMPORARILY
- LAND NOT SUBJECT TO COMPULSORY ACQUISITION

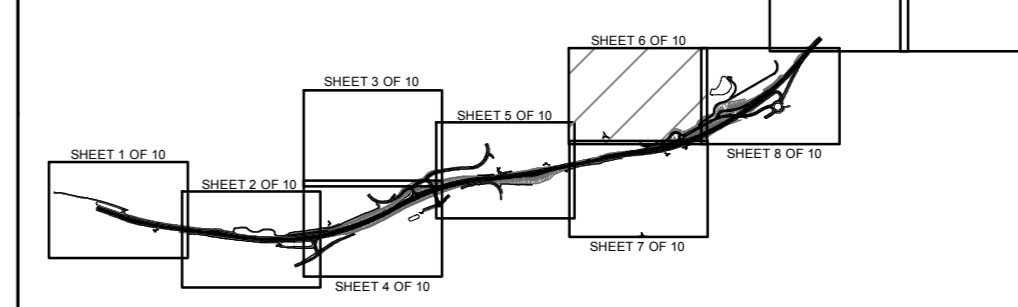

Project Title: **A303 SPARKFORD TO ILCHESTER DUALLING**

Drawing Title: **LAND PLANS REGULATION 5(2)(i) SHEET 6 OF 10**

Drawing Status: **PUBLISHED - DEFINITION** Suitability: **A3**

Scale: 1:1,250	Designed: GP	Drawn: GP	Checked: AL	Approved: ER
Original Size: A1	Date: 06/06/18	Date: 11/07/18	Date: 16/07/18	Date: 16/07/18

REV.	DATE	AMENDMENT DETAILS	ORIG	CH'D	APP'D
C04	26/03/2019	SUBMISSION FOR DEADLINE 5	GP	JM	ER
C01	16/07/2018	DCO SUBMISSION	GP	AL	ER

Drawing Number: **HE551507** | Originator: **MMSJV** | Volume: **LSI**

Location: **000** | Type: **DR** | Role: **UU** | Number: **2022**

Project Ref. No.: **389107** | Revision: **C04**

Scale: 0 30 60 90 120 Metres

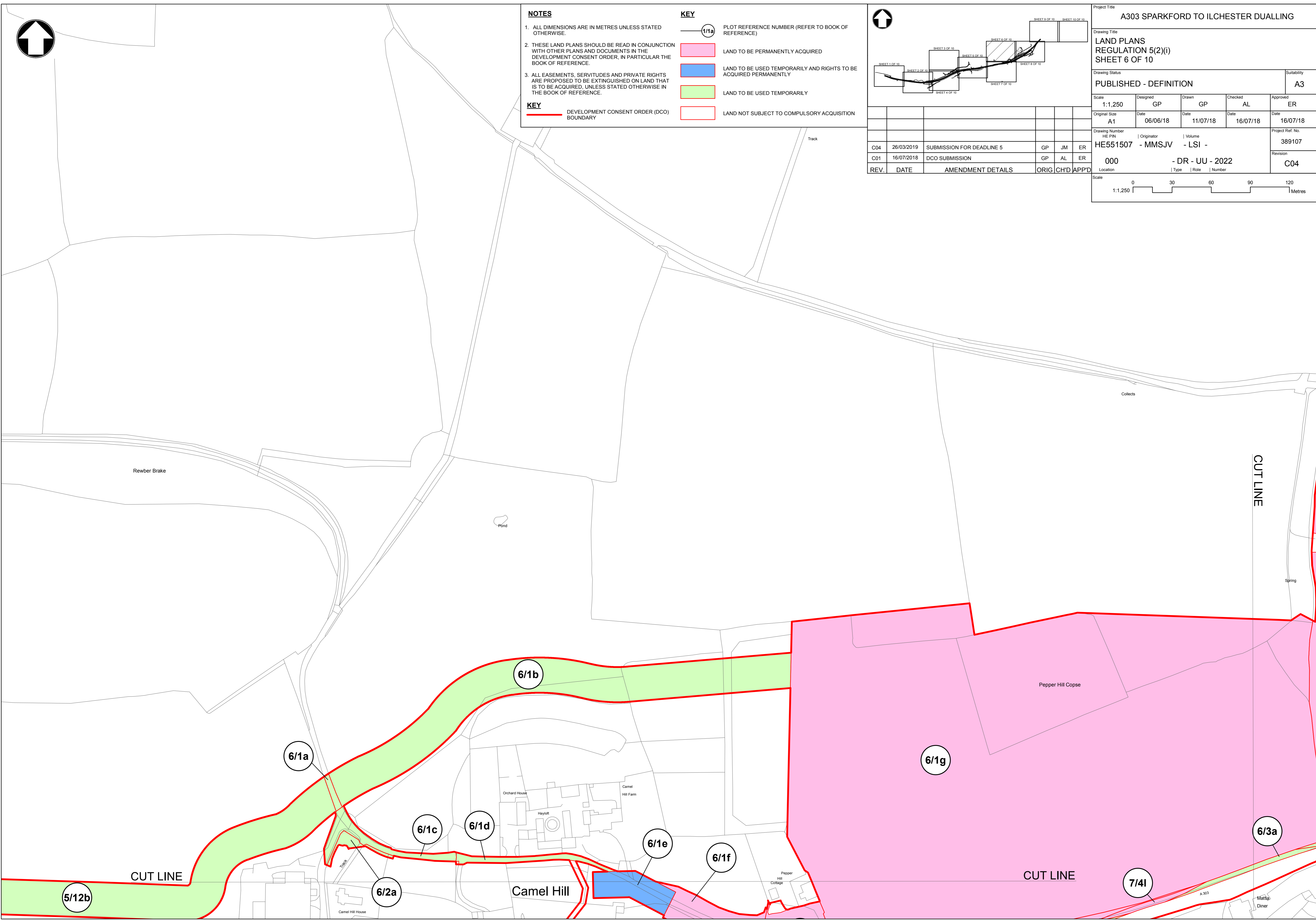

PLEASE NOTE THE OS DATA DISPLAYED IS IN ADHERENCE TO © CROWN COPYRIGHT AND DATABASE RIGHTS 2018 OS 100030649. THIS DOCUMENT IS ISSUED FOR THE PARTY WHICH COMMISSIONED IT AND FOR SPECIFIC PURPOSES CONNECTED WITH THE CAPTIONED PROJECT ONLY. IT SHOULD NOT BE RELIED UPON BY ANY OTHER PARTY OR USED FOR ANY OTHER PURPOSE. WE ACCEPT NO RESPONSIBILITY FOR THE CONSEQUENCES OF THIS DOCUMENT BEING RELIED UPON BY ANY OTHER PARTY, OR BEING USED FOR ANY OTHER PURPOSE, OR CONTAINING ANY ERROR OR OMISSION WHICH IS DUE TO AN ERROR OR OMISSION IN DATA SUPPLIED TO US BY OTHER PARTIES.

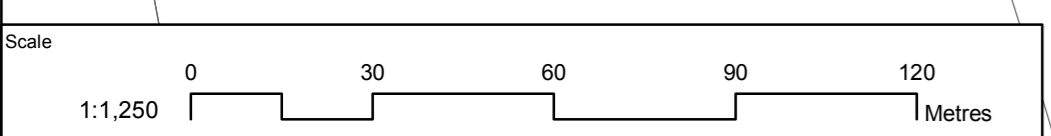
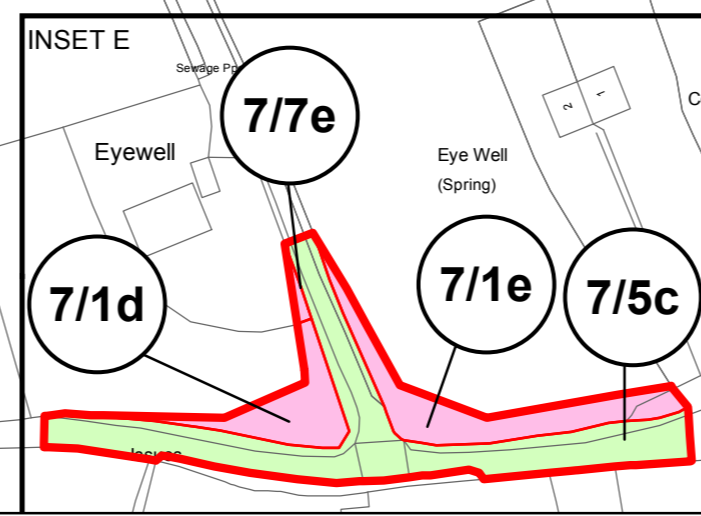
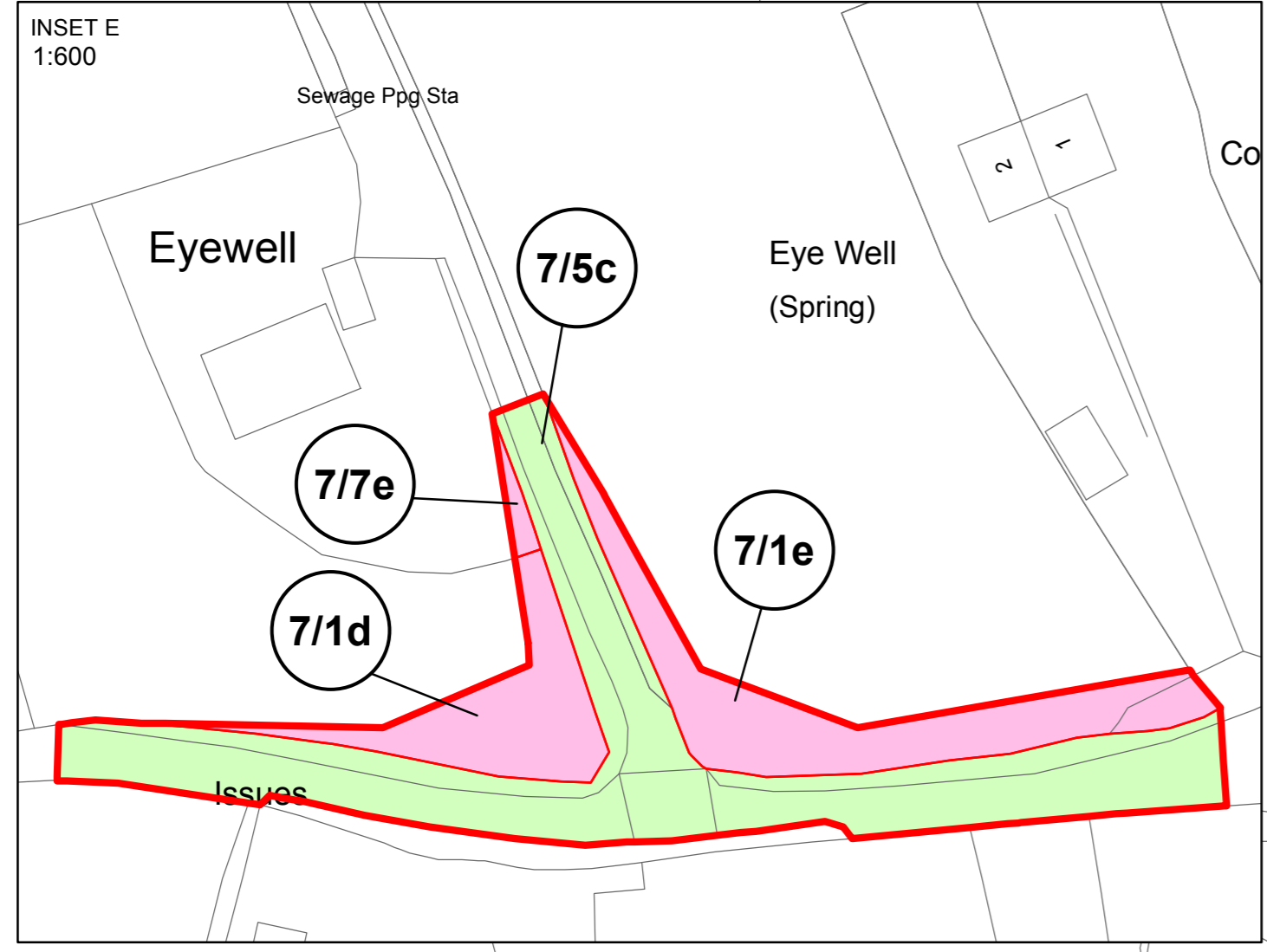
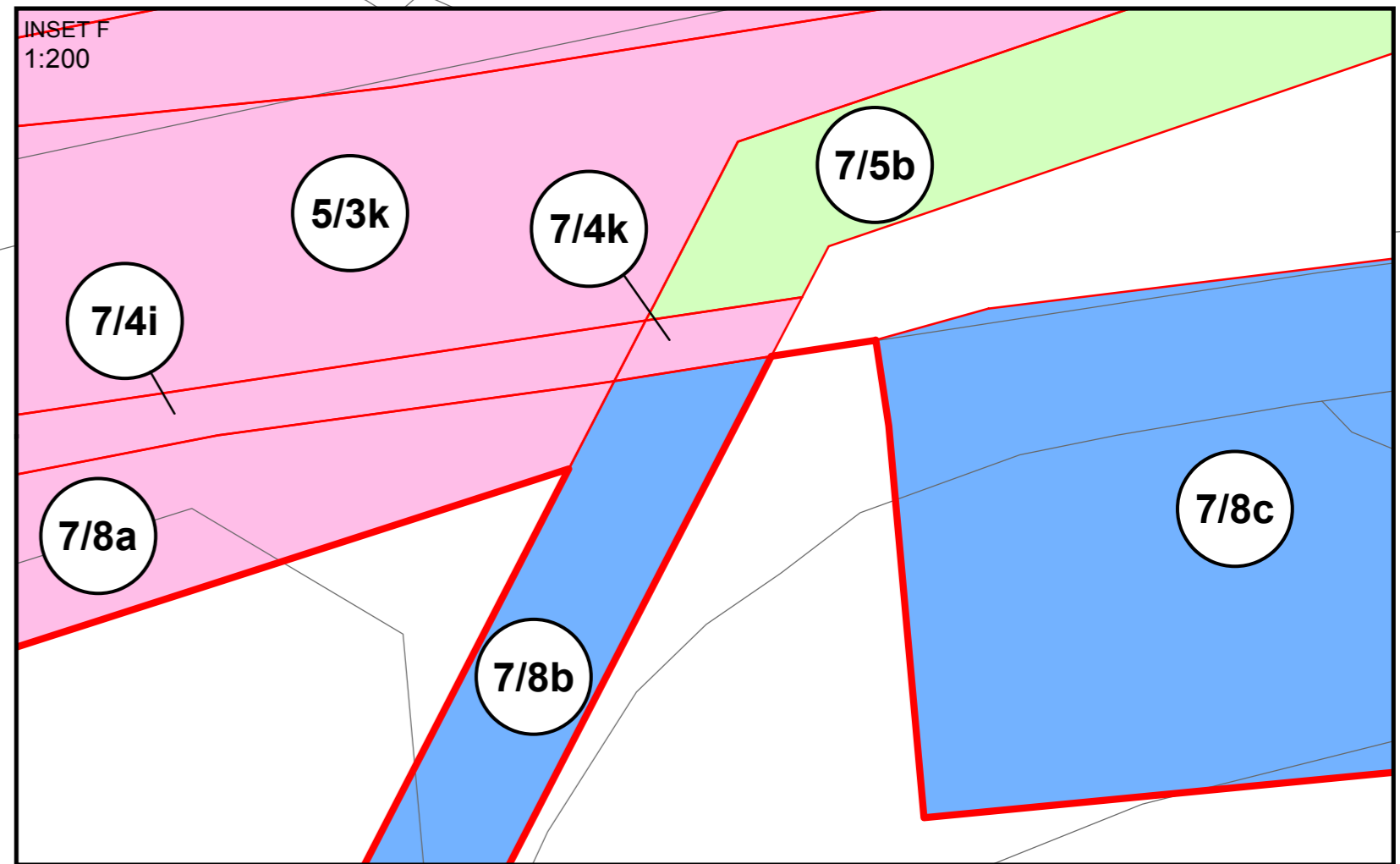
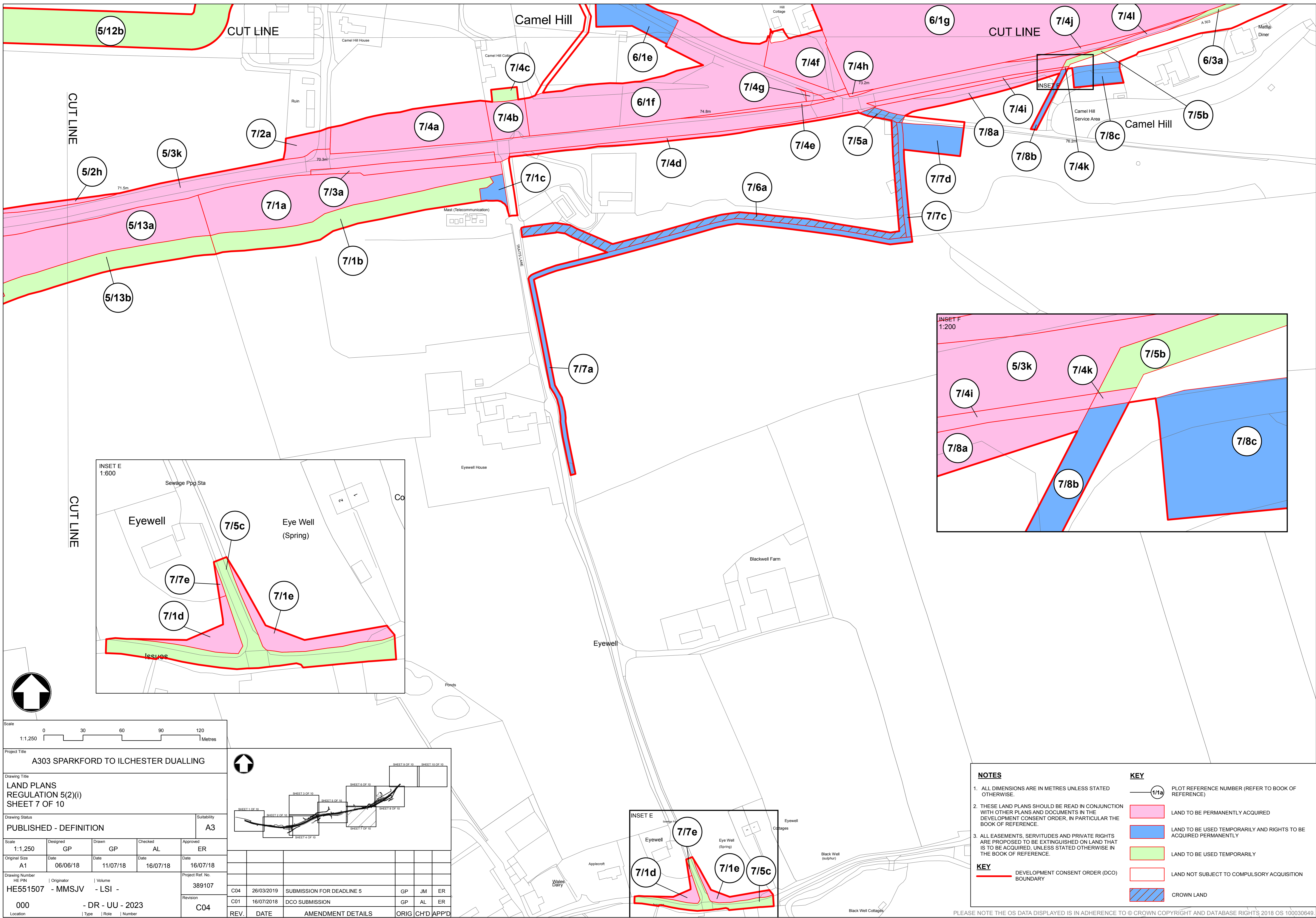

Project Title A303 SPARKFORD TO ILCHESTER DUALLING					
Drawing Title LAND PLANS REGULATION 5(2)(i) SHEET 7 OF 10					
Drawing Status PUBLISHED - DEFINITION					Subsidiarity A3
Scale 1:1,250	Designed GP	Drawn GP	Checked AL	Approved ER	
Original Size A1	Date 06/06/18	Date 11/07/18	Date 16/07/18	Date 16/07/18	
Drawing Number HE551507	Originator - MMSJV	Volume - LSI -	Project Ref. No. 389107		
000	- DR - UU - 2023		Revision C04		
Location		Type	Role	Number	

REV.	DATE	AMENDMENT DETAILS	ORIG	CHD	APPD
C04	26/03/2019	SUBMISSION FOR DEADLINE 5	GP	JM	ER
C01	16/07/2018	DCO SUBMISSION	GP	AL	ER

NOTES

- ALL DIMENSIONS ARE IN METRES UNLESS STATED OTHERWISE.
- THESE LAND PLANS SHOULD BE READ IN CONJUNCTION WITH OTHER PLANS AND DOCUMENTS IN THE DEVELOPMENT CONSENT ORDER, IN PARTICULAR THE BOOK OF REFERENCE.
- ALL EASEMENTS, SERVITUDES AND PRIVATE RIGHTS ARE PROPOSED TO BE EXTINGUISHED ON LAND THAT IS TO BE ACQUIRED, UNLESS STATED OTHERWISE IN THE BOOK OF REFERENCE.

KEY

	LAND TO BE PERMANENTLY ACQUIRED		PLOT REFERENCE NUMBER (REFER TO BOOK OF REFERENCE)
	LAND TO BE USED TEMPORARILY AND RIGHTS TO BE ACQUIRED PERMANENTLY		LAND NOT SUBJECT TO COMPULSORY ACQUISITION
	LAND TO BE USED TEMPORARILY		CROWN LAND
	DEVELOPMENT CONSENT ORDER (DCO) BOUNDARY		

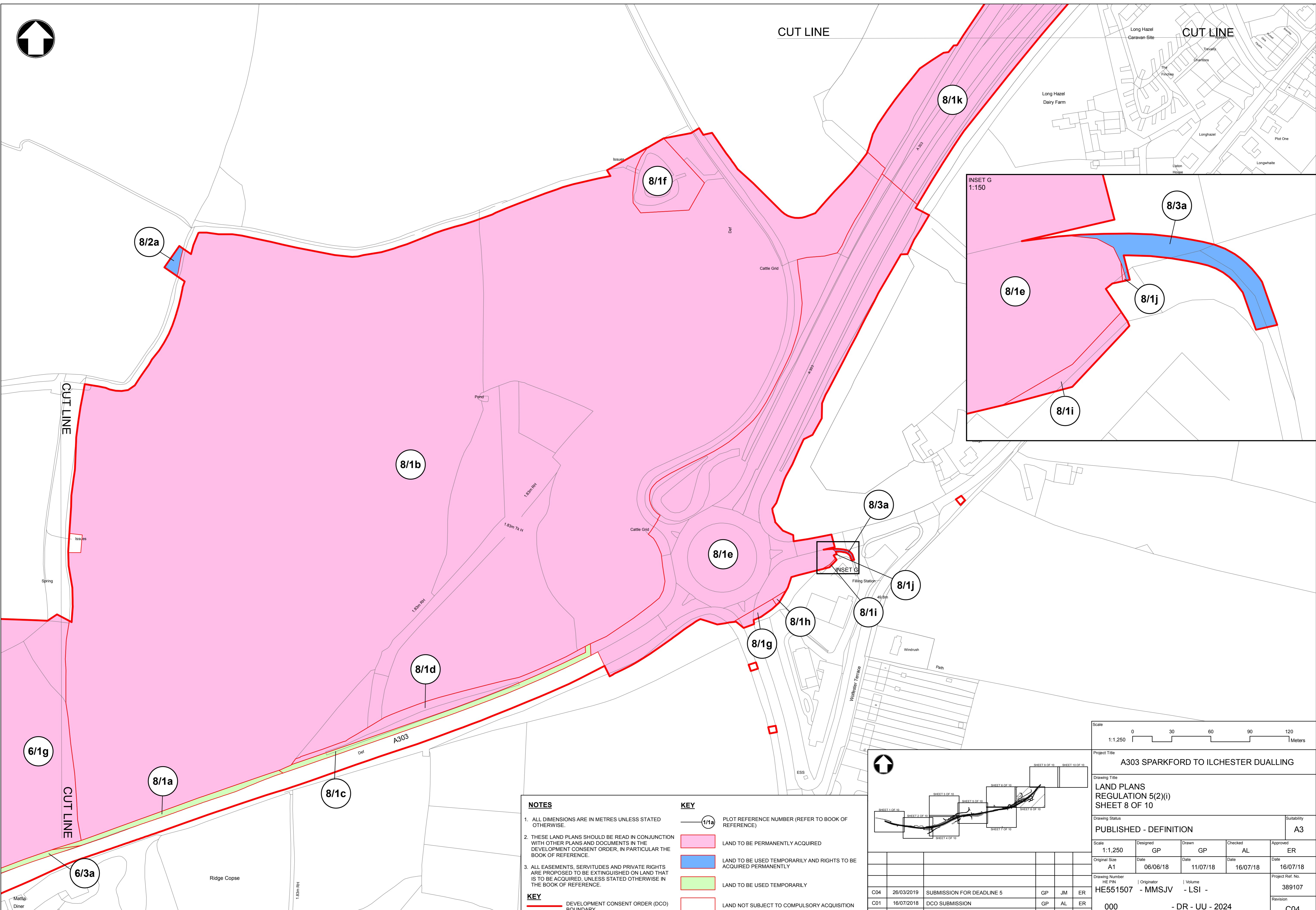

NOTES

- ALL DIMENSIONS ARE IN METRES UNLESS STATED OTHERWISE.
- THESE LAND PLANS SHOULD BE READ IN CONJUNCTION WITH OTHER PLANS AND DOCUMENTS IN THE DEVELOPMENT CONSENT ORDER, IN PARTICULAR THE BOOK OF REFERENCE.
- ALL EASEMENTS, SERVITUDES AND PRIVATE RIGHTS ARE PROPOSED TO BE EXTINGUISHED ON LAND THAT IS TO BE ACQUIRED, UNLESS STATED OTHERWISE IN THE BOOK OF REFERENCE.

KEY

- (1/1a) PLOT REFERENCE NUMBER (REFER TO BOOK OF REFERENCE)
- LAND TO BE PERMANENTLY ACQUIRED
- LAND TO BE USED TEMPORARILY AND RIGHTS TO BE ACQUIRED PERMANENTLY
- LAND TO BE USED TEMPORARILY
- DEVELOPMENT CONSENT ORDER (DCO) BOUNDARY
- LAND NOT SUBJECT TO COMPULSORY ACQUISITION

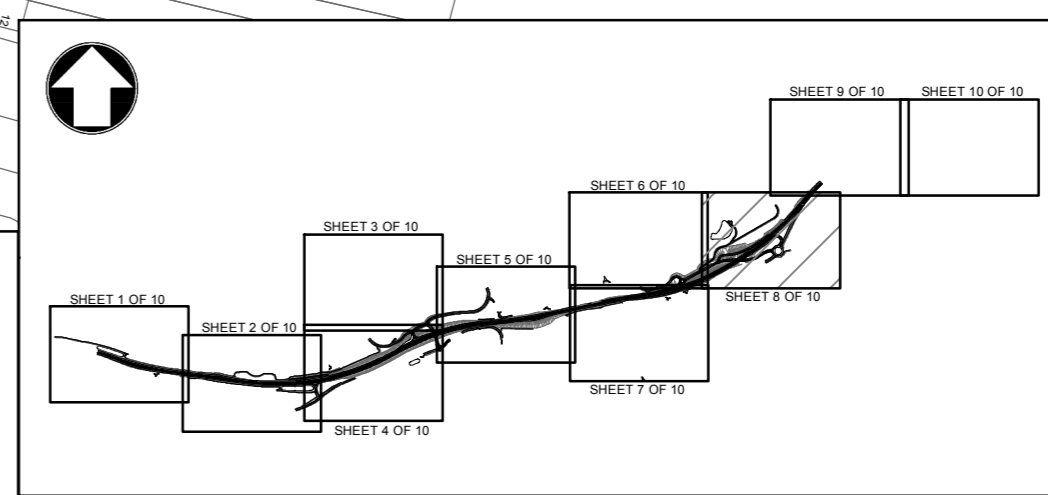

Scale 1:1,250 0 30 60 90 120 Meters					
Project Title A303 SPARKFORD TO ILCHESTER DUALLING					
Drawing Title LAND PLANS REGULATION 5(2)(i) SHEET 8 OF 10					
Drawing Status PUBLISHED - DEFINITION					Suitability A3
Scale 1:1,250	Designed GP	Drawn GP	Checked AL	Approved ER	
Original Size A1	Date 06/06/18	Date 11/07/18	Date 16/07/18	Date 16/07/18	
Drawing Number HE PIN	Originator MMSJV	Volume LSI	Project Ref. No. 389107		
000	- DR - UU - 2024		Revision C04		
Location	Type	Role	Number		

REV.	DATE	AMENDMENT DETAILS	ORIG	CHD	APPD
C04	26/03/2019	SUBMISSION FOR DEADLINE 5	GP	JM	ER
C01	16/07/2018	DCO SUBMISSION	GP	AL	ER

PLEASE NOTE THE OS DATA DISPLAYED IS IN ADHERENCE TO © CROWN COPYRIGHT AND DATABASE RIGHTS 2018 OS 100030649.
THIS DOCUMENT IS ISSUED FOR THE PARTY WHICH COMMISSIONED IT AND FOR SPECIFIC PURPOSES CONNECTED WITH THE CAPTIONED PROJECT ONLY. IT SHOULD NOT BE RELIED UPON BY ANY OTHER PARTY OR USED FOR ANY OTHER PURPOSE.
WE ACCEPT NO RESPONSIBILITY FOR THE CONSEQUENCES OF THIS DOCUMENT BEING RELIED UPON BY ANY OTHER PARTY, OR BEING USED FOR ANY OTHER PURPOSE, OR CONTAINING ANY ERROR OR OMISSION WHICH IS DUE TO AN ERROR OR OMISSION IN DATA SUPPLIED TO US BY OTHER PARTIES.

THIS DOCUMENT IS ISSUED FOR THE PARTY WHICH COMMISSIONED IT AND FOR SPECIFIC PURPOSES CONNECTED WITH THE CAPTIONED PROJECT ONLY, IT SHOULD NOT BE RELIED UPON BY ANY OTHER PARTY OR USED FOR ANY OTHER PURPOSE. WE ACCEPT NO RESPONSIBILITY FOR THE CONSEQUENCES OF THIS DOCUMENT BEING RELIED UPON BY ANY OTHER PARTY, OR BEING USED FOR ANY OTHER PURPOSE, OR CONTAINING ANY ERROR OR OMISSION WHICH IS DUE TO AN ERROR OR OMISSION IN DATA SUPPLIED TO US BY OTHER PARTIES. PLEASE NOTE THE OS DATA DISPLAYED IS IN ADHERENCE TO © CROWN COPYRIGHT AND DATABASE RIGHTS 2018 OS 100030649.



NOTES

1. ALL DIMENSIONS ARE IN METRES UNLESS STATED OTHERWISE.
2. THESE LAND PLANS SHOULD BE READ IN CONJUNCTION WITH OTHER PLANS AND DOCUMENTS IN THE DEVELOPMENT CONSENT ORDER, IN PARTICULAR THE BOOK OF REFERENCE.
3. ALL EASEMENTS, SERVITUDES AND PRIVATE RIGHTS ARE PROPOSED TO BE EXTINGUISHED ON LAND THAT IS TO BE ACQUIRED, UNLESS STATED OTHERWISE IN THE BOOK OF REFERENCE.

KEY

— (1/1a) PLOT REFERENCE NUMBER (REFER TO BOOK OF REFERENCE)

- LAND TO BE PERMANENTLY ACQUIRED
- LAND TO BE USED TEMPORARILY AND RIGHTS TO BE ACQUIRED PERMANENTLY
- LAND TO BE USED TEMPORARILY
- LAND NOT SUBJECT TO COMPULSORY ACQUISITION

KEY

- DEVELOPMENT CONSENT ORDER (DCO) BOUNDARY

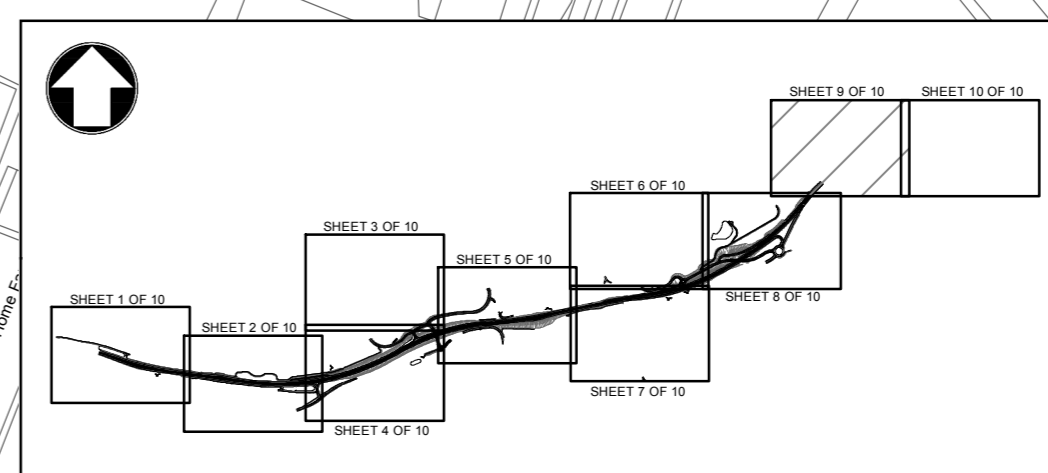
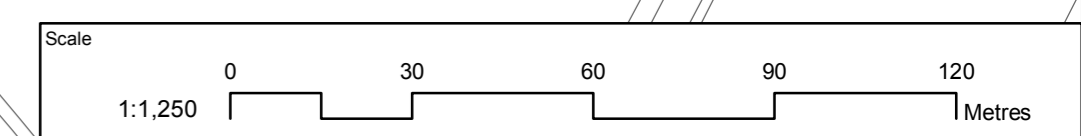
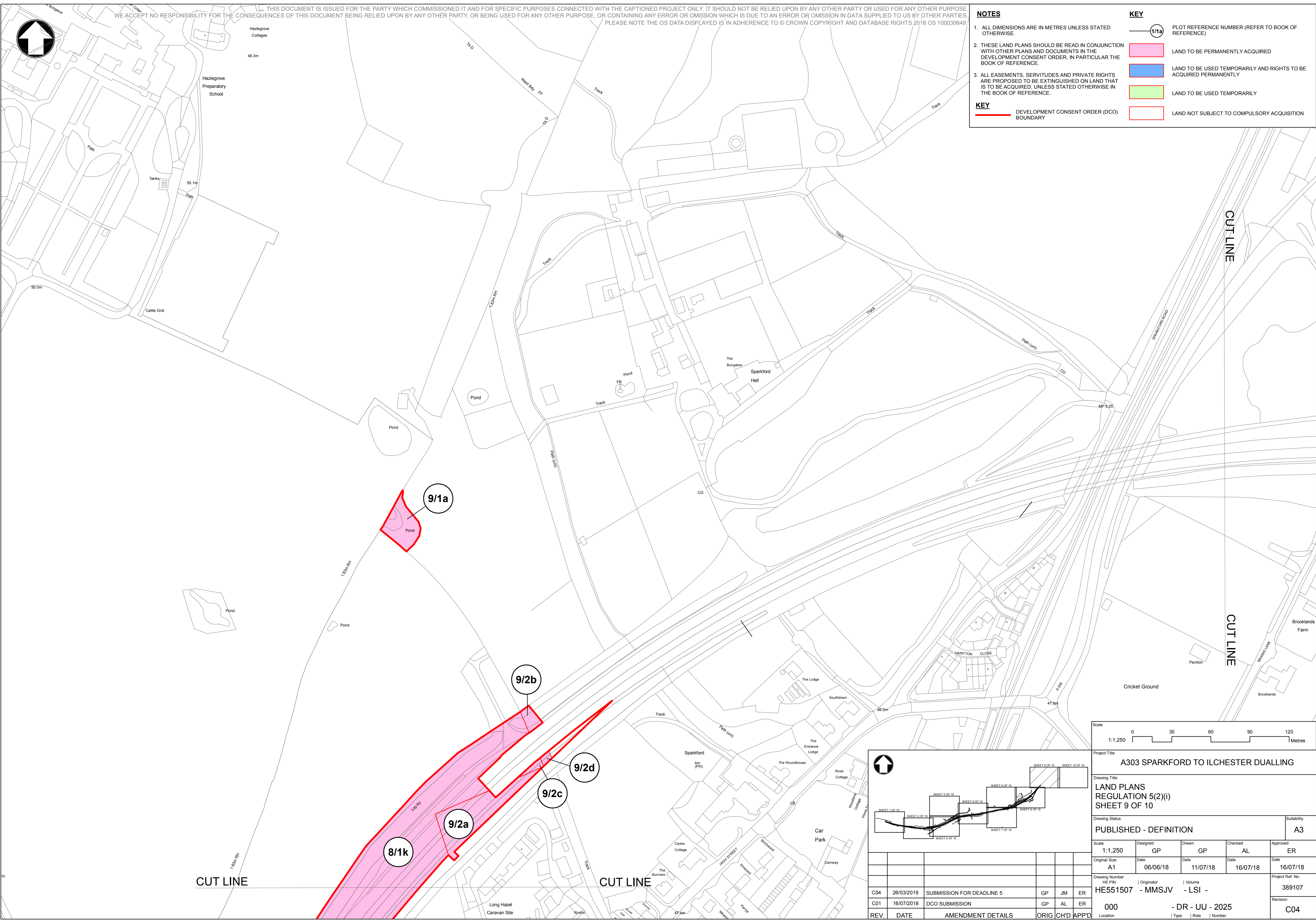

Scale					
1:1,250	0	30	60	90	120
Metres					
Project Title					
A303 SPARKFORD TO ILCHESTER DUALLING					
Drawing Title					
LAND PLANS REGULATION 5(2)(i) SHEET 9 OF 10					
Drawing Status					Suitability
PUBLISHED - DEFINITION					A3
Scale	Designed	Drawn	Checked	Approved	
1:1,250	GP	GP	AL	ER	
Original Size	Date	Date	Date	Date	
A1	06/06/18	11/07/18	16/07/18	16/07/18	
Drawing Number	Originator	Volume	Project Ref. No.		
HE PIN	- MMSJV	- LSI -	389107		
000	- DR - UU - 2025		Revision		
Location	Type	Role	Number		
			C04		
REV.	DATE	AMENDMENT DETAILS	ORIG	CHD	APPD
C04	26/03/2019	SUBMISSION FOR DEADLINE 5	GP	JM	ER
C01	16/07/2018	DCO SUBMISSION	GP	AL	ER

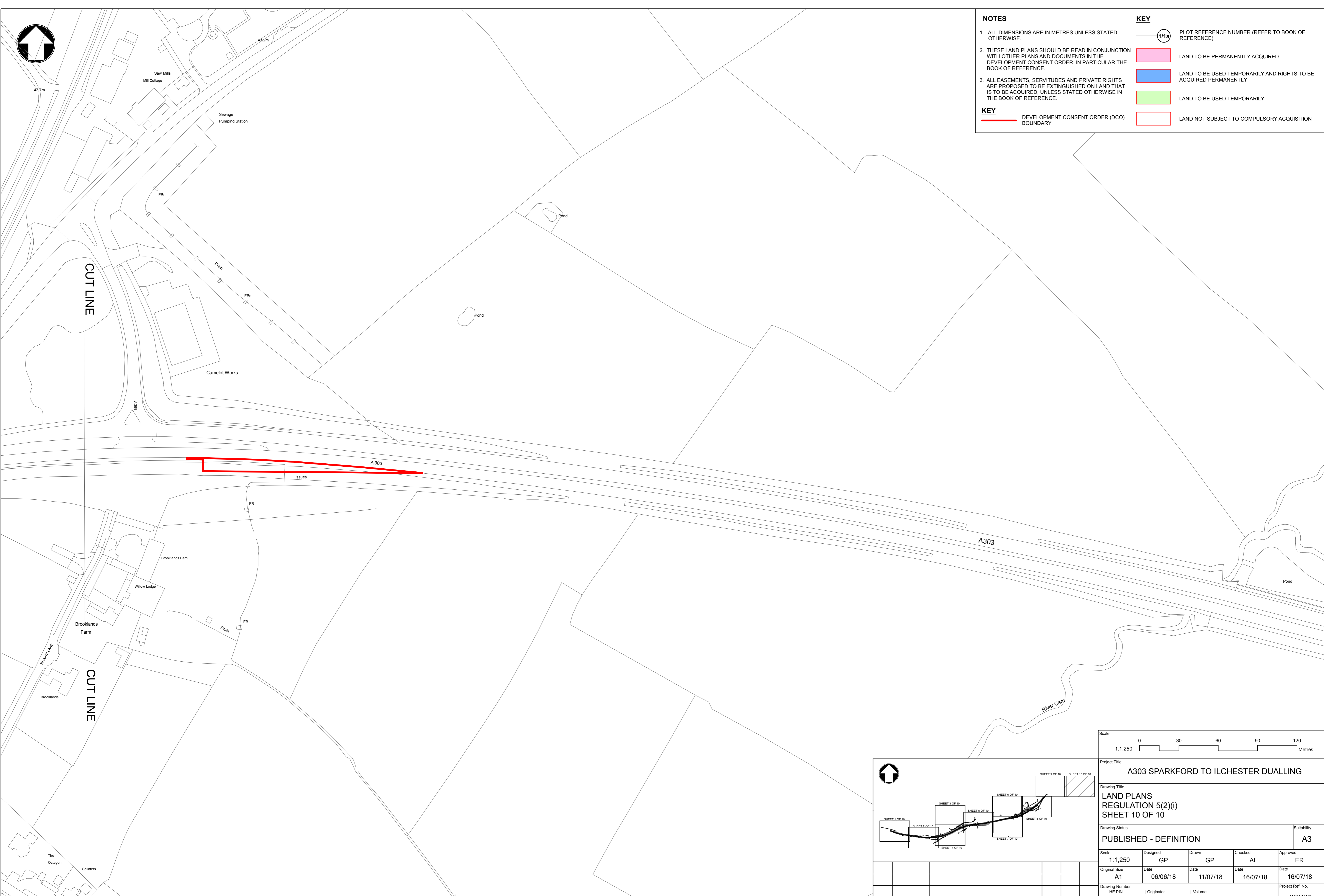

NOTES

1. ALL DIMENSIONS ARE IN METRES UNLESS STATED OTHERWISE.
2. THESE LAND PLANS SHOULD BE READ IN CONJUNCTION WITH OTHER PLANS AND DOCUMENTS IN THE DEVELOPMENT CONSENT ORDER, IN PARTICULAR THE BOOK OF REFERENCE.
3. ALL EASEMENTS, SERVITUDES AND PRIVATE RIGHTS ARE PROPOSED TO BE EXTINGUISHED ON LAND THAT IS TO BE ACQUIRED, UNLESS STATED OTHERWISE IN THE BOOK OF REFERENCE.

KEY

- DEVELOPMENT CONSENT ORDER (DCO) BOUNDARY
- PLOT REFERENCE NUMBER (REFER TO BOOK OF REFERENCE)
- LAND TO BE PERMANENTLY ACQUIRED
- LAND TO BE USED TEMPORARILY AND RIGHTS TO BE ACQUIRED PERMANENTLY
- LAND TO BE USED TEMPORARILY
- LAND NOT SUBJECT TO COMPULSORY ACQUISITION

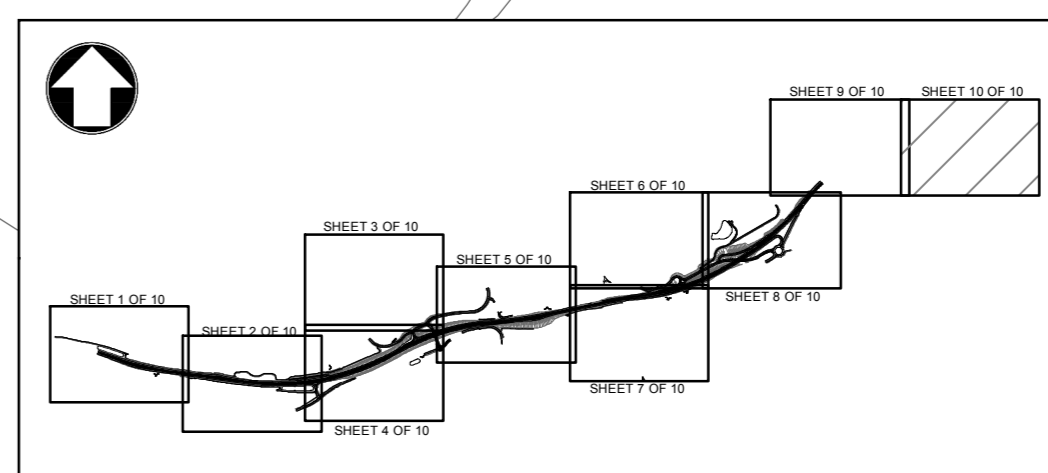
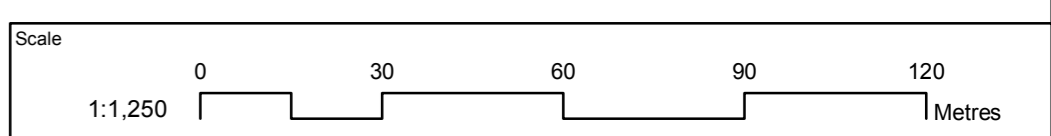

Scale 1:1,250					
Project Title A303 SPARKFORD TO ILCHESTER DUALLING					
Drawing Title LAND PLANS REGULATION 5(2)(i) SHEET 10 OF 10					
Drawing Status PUBLISHED - DEFINITION					Suitability A3
Scale 1:1,250	Designed GP	Drawn GP	Checked AL	Approved ER	
Original Size A1	Date 06/06/18	Date 11/07/18	Date 16/07/18	Date 16/07/18	
Drawing Number HE PIN 000	Originator - MMSJV	Volume - LSI -	Project Ref. No. 389107		
REV. C04	DATE 26/03/2019	AMENDMENT DETAILS SUBMISSION FOR DEADLINE 5	ORIG GP	CHD JM	APPD ER
REV. C01	DATE 16/07/2018	AMENDMENT DETAILS DCO SUBMISSION	ORIG GP	CHD AL	APPD ER
Location 000			Type - DR - UU - 2026		Revision C04

PLEASE NOTE THE OS DATA DISPLAYED IS IN ADHERENCE TO © CROWN COPYRIGHT AND DATABASE RIGHTS 2018 OS 100030649.
THIS DOCUMENT IS ISSUED FOR THE PARTY WHICH COMMISSIONED IT AND FOR SPECIFIC PURPOSES CONNECTED WITH THE CAPTIONED PROJECT ONLY. IT SHOULD NOT BE RELIED UPON BY ANY OTHER PARTY OR USED FOR ANY OTHER PURPOSE.
WE ACCEPT NO RESPONSIBILITY FOR THE CONSEQUENCES OF THIS DOCUMENT BEING RELIED UPON BY ANY OTHER PARTY, OR BEING USED FOR ANY OTHER PURPOSE, OR CONTAINING ANY ERROR OR OMISSION WHICH IS DUE TO AN ERROR OR OMISSION IN DATA SUPPLIED TO US BY OTHER PARTIES.